

25 Alderford Street - Guide Price £275,000

Sible Hedingham CO9 3HX

scott maddison

Estate & Letting Agents



"Consistently providing outstanding service to our clients"

Guide Price £275,000

The Property

Nestled on Alderford Street in the charming village of Sible Hedingham, this delightful mid-terrace house offers a perfect blend of character and modern living.

With an inviting reception room and separate conservatory, this property provides ample space for both relaxation and entertaining. The lounge features a cosy log burner and the natural light throughout the home creates a warm and inviting atmosphere.

The house boasts two well-proportioned bedrooms, providing comfortable accommodation for individuals, couples, or small families. The bathroom is located on the first floor, ensuring practicality for everyday living.

Sible Hedingham is known for its picturesque surroundings and community spirit. All amenities including shops, schools and parks are all within a short distance.

This mid-terrace house presents an excellent opportunity for first-time buyers, small families, or those looking to downsize. With its charming features and prime location, it is a property that truly deserves your attention. Do not miss the chance to make this lovely house your new home.

Features

- Two Bedroom Terraced Property
- Fantastic Condition
- Close To Local Amenities
- Quiet Location with Garden
- No Onward Chain
- Modern Kitchen
- Council Tax B
- EPC C
- Log Burner
- Conservatory





These sales particulars have been produced as a general guide only and we would draw to your attention that we have not carried out a detailed Survey of the property nor have we tested services, appliances or specific fittings. Whilst measurements and statements given within the details are provided in good faith, their accuracy should not be relied upon. If there are any points about which you may be uncertain or would like further clarification, we would suggest that you telephone this office and speak to our staff who will endeavour to assist you.

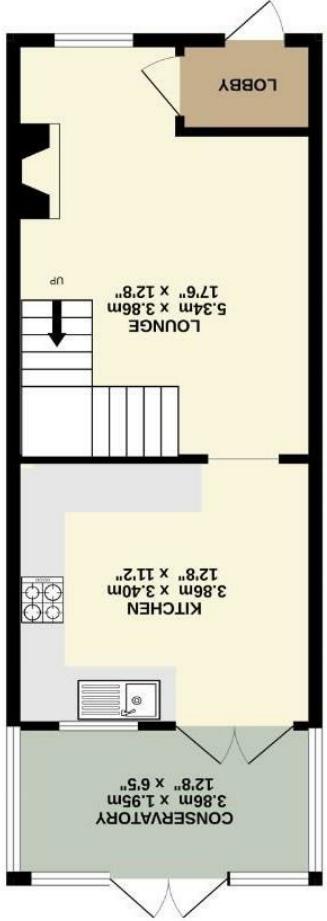

GROUND FLOOR (437 sq.ft.) approx.

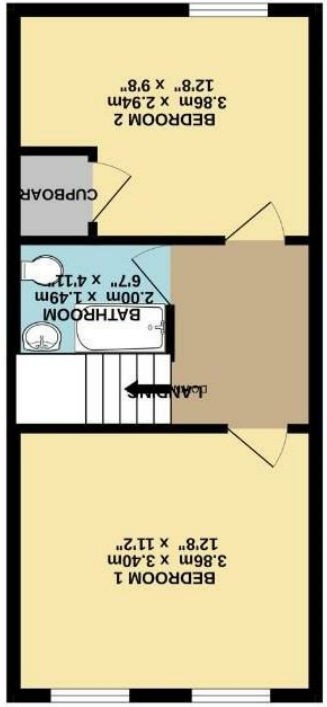

1ST FLOOR (363 sq.ft.) approx.

Whilst every attempt has been made to ensure the accuracy of the description contained here, measurements of house, windows, doors and any other items are approximate and no responsibility is taken for any inaccuracy or misstatement. This plan is for illustrative purposes only and should be used as such by any prospective purchaser. The services, systems and appliances shown have not been tested and no guarantee as to their operability or efficiency can be given.

Made with Housify e2025

